



For Lease

\$1.00
PSF NNN

Contact us:

Preston Thomas, SIOR
Senior VP | Principal
License #01378821
Office: +1 805 544 3900



Colliers | San Luis Obispo
1301 Chorro Street
San Luis Obispo, CA 93401
P: +1 805 544 3900
www.colliers.com

2105 Wisteria Lane Paso Robles, CA

Warehouse Flex Space
in Popular Business Park

Property Summary

Stand-alone, modern warehouse flex space in a popular business park near the Golden Hill/Highway 46 intersection. Building includes 20' ceilings, 12' X 12' roll-up doors and storefronts. Block construction. Space will be in industrial vanilla shell form and include ADA restroom, 3 phase electrical lighting/outlets and a gas ceiling heater. Perfect for wine storage, light manufacturing, or showroom uses.

Located in same development as Justin Vineyard, IQMS, Wine Direct and San Antonio Winery.

Size	± 8,885 SF - Entire stand-alone building
Rate	\$1.00 PSF NNN (~\$0.35)
Property Type	Warehouse with roll-up doors
Zoning	PM Planned Industrial
Parking	Large parking lot on-site

Floorplan

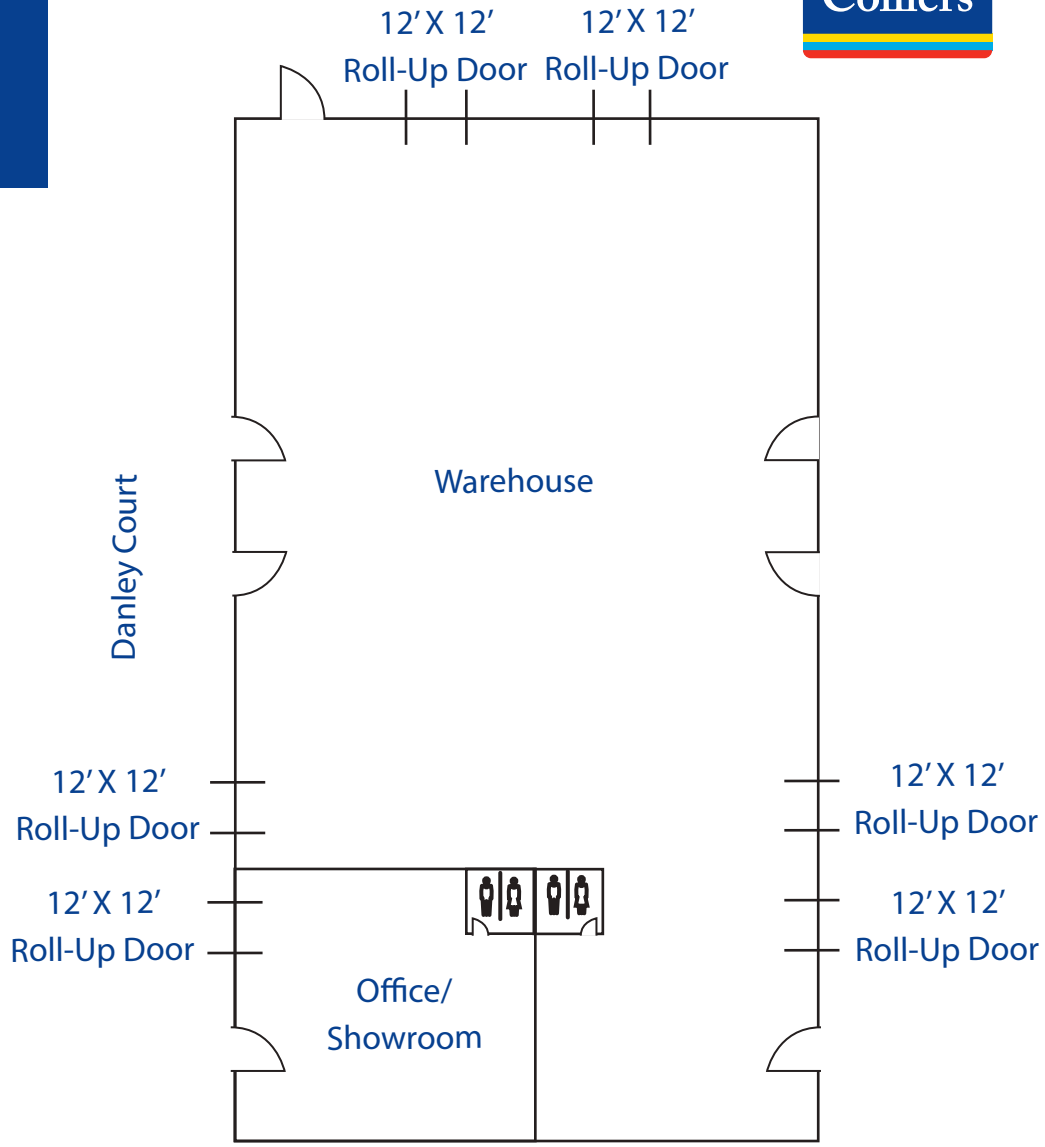

Wisteria Lane

* Floor plan is approximate

Size	± 8,885 SF
Rate	\$1.00 PSF NNN (~\$0.35)
Property Type	Warehouse with roll-up doors
Zoning	PM Planned Industrial
Parking	Large parking lot on-site

Contact

Preston Thomas, SIOR
 Senior VP | Principal
 License #01378821
 Office: +1 805 544 3900
 preston.h.thomas@colliers.com



Colliers | San Luis Obispo
 1301 Chorro Street
 San Luis Obispo, CA 93401
 P: +1 805 544 3900
 www.colliers.com

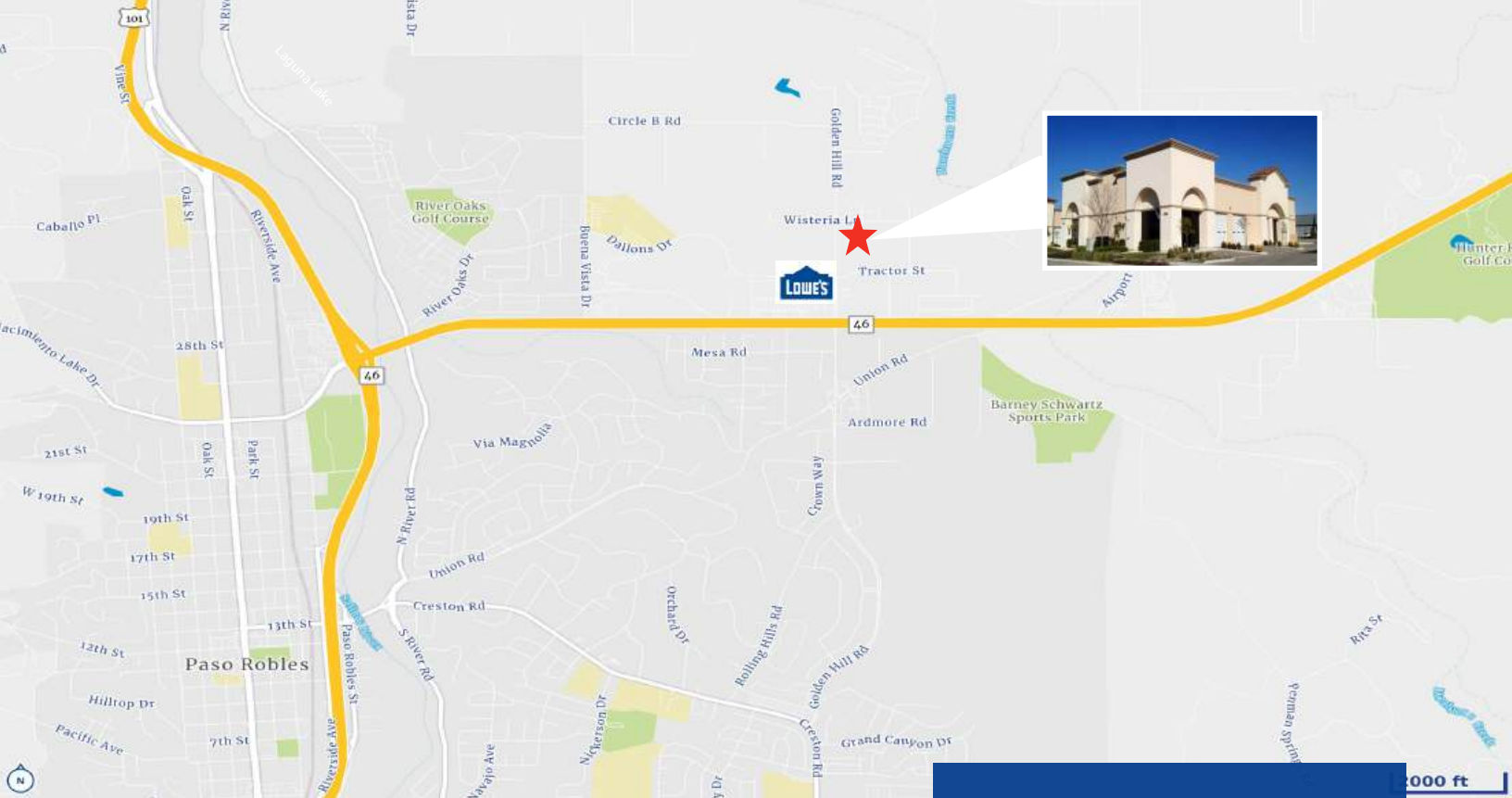

Contact:

Preston Thomas, SIOR

Senior VP | Principal

License #01378821

Office: +1 805 544 3900



Colliers | San Luis Obispo

1301 Chorro Street

San Luis Obispo, CA 93401

P: +1 805 544 3900

www.colliers.com