



Accelerating success.



For Lease

\$1.10
PSF NNN

Contact us:

Preston Thomas, SIOR
Senior VP | Principal
License #01378821
Office: +1 805 544 3900



Colliers | San Luis Obispo
1301 Chorro Street
San Luis Obispo, CA 93401
P: +1 805 544 3900
www.colliers.com

2103 Wisteria Lane Paso Robles, CA

Warehouse Flex Space
in Popular Business Park

Property Summary

High exposure corner. Newer warehouse flex space in a popular business park near the Golden Hill/Highway 46 intersection. Building includes 20' ceilings, 12' X 12' roll-up doors and storefronts. Block construction. Space will be in industrial vanilla shell form and include ADA restroom, 3 phase electrical lighting/outlets and a gas ceiling heater.

Perfect for wine storage, light manufacturing, or showroom uses, to name a few. Located in same development as Justin Vineyard, IQMS, Wine Direct and San Antonio Winery.

Size	± 2,960 SF
Rate	\$1.10 PSF NNN (~\$0.35)
Property Type	Warehouse with roll-up doors
Zoning	PM Planned Industrial
Parking	Large parking lot on-site

Accelerating success.

Floorplan



Danley Court

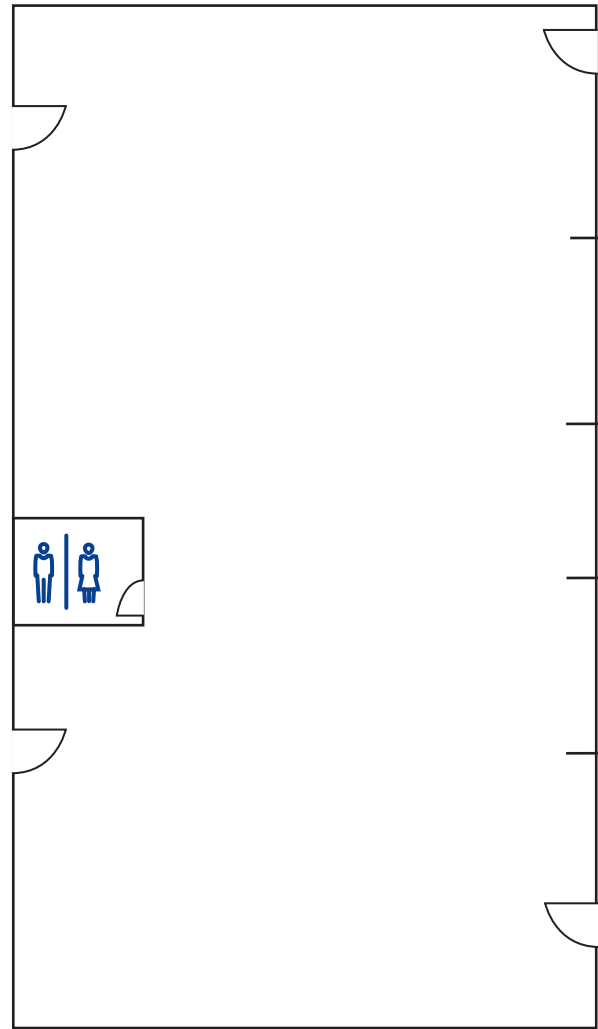

12' X 12'
Roll-Up Door

12' X 12'
Roll-Up Door

Wisteria Lane

* Floor plan is approximate

Size	± 2,960 SF
Rate	\$1.10 PSF NNN
Property Type	Warehouse with roll-up doors
Zoning	PM Planned Industrial
Parking	Large parking lot on-site

Contact

Preston Thomas, SIOR
Senior VP | Principal
License #01378821
Office: +1 805 544 3900
preston.h.thomas@colliers.com



Colliers | San Luis Obispo
1301 Chorro Street
San Luis Obispo, CA 93401
P: +1 805 544 3900
www.colliers.com

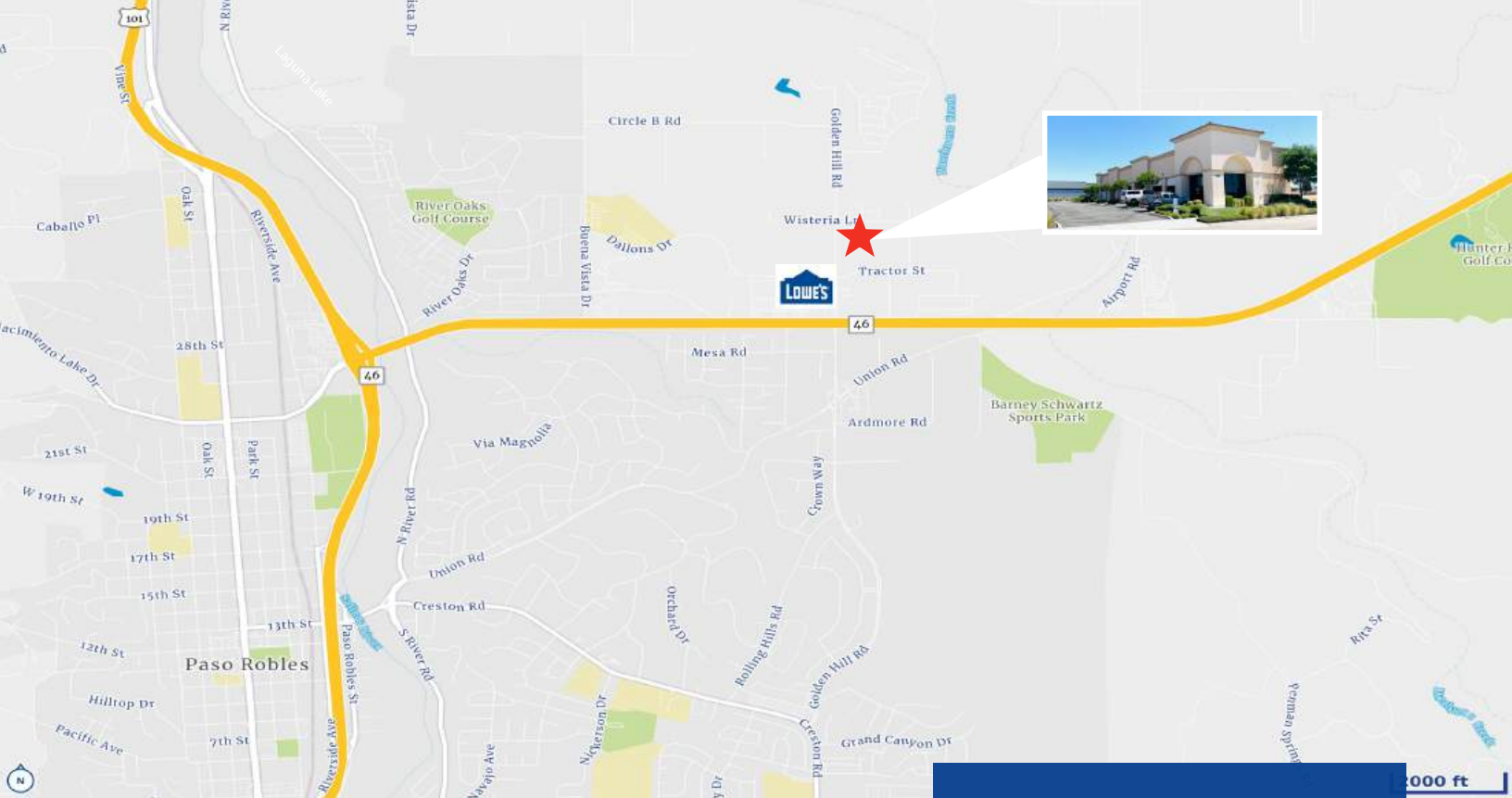

Contact:

Preston Thomas, SIOR

Senior VP | Principal

License #01378821

Office: +1 805 544 3900



Colliers | San Luis Obispo

1301 Chorro Street

San Luis Obispo, CA 93401

P: +1 805 544 3900

www.colliers.com